

WARNING

YOU COULD BE KILLED OR SERIOUSLY INJURED IF YOU DO NOT READ AND UNDERSTAND THE USER INSTRUCTION BEFORE USING THIS PIECE OF EQUIPMENT.

SPECIAL TRAINING AND KNOWLEDGE ARE REQUIRED TO USE THIS EQUIPMENT.

YOU MUST THOROUGHLY READ AND UNDERSTAND ALL MANUFACTURER'S INSTRUCTIONS BEFORE USE.

USE AND INSPECT THIS EQUIPMENT ONLY IN ACCORDANCE WITH THESE INSTRUCTIONS.

THIS SHEET HAS BEEN PREPARED IN ACCORDANCE WITH THE REQUIREMENTS OF NFPA 1983.



SUPPLEMENTAL NFPA INFORMATION:
EMERGENCY SERVICES DESCENT CONTROL DEVICE IN ACCORDANCE WITH NFPA 1983-2017.

MEETS THE DESCENT CONTROL DEVICE REQUIREMENTS OF NFPA 1983, STANDARD ON LIFE SAFETY ROPE AND EQUIPMENT FOR EMERGENCY SERVICES, 2017 EDITION.

THIS SMC RAPPEL RACK ASSEMBLY HAS PASSED THE MANNER OF FUNCTION AND HOLDING LOAD TEST USING THE FOLLOWING ROPES:

Bluewater Rope, Safeline, 9.5mm
PMI, Classic Pro Max, 16.0mm

Also performs with similar ropes made by other technical rope manufacturers.

The NFPA certified devices are designed to be used with rope diameters ranging from 9.5mm to 16mm. When tested with 9.5 to 12.5mm ropes, the device is rated "T" for technical use loads with an MBS of 13.5kN. When tested with 11 to 16mm ropes, the device is rated "G" for general use loads with an MBS of 22kN.

ADDITIONAL INFORMATION

Additional information regarding this type of equipment can be found in the following publications:

NFPA 1500, *Standard on Fire Department Occupational Safety and Health Program*

NFPA 1983, *Standard on Life Safety Rope and Equipment for Emergency Services.*

CAUTION

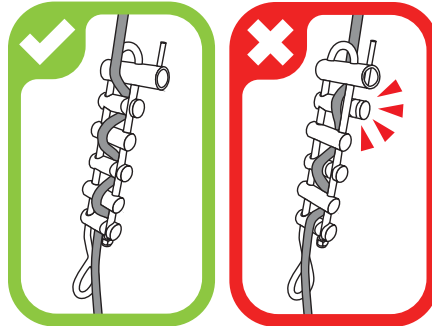

When using a brake bar rack, always load the rope so that it forces the slotted bars against the frame. IMPROPERLY RIGGING THE ROPE COULD RESULT IN INJURY OR DEATH.

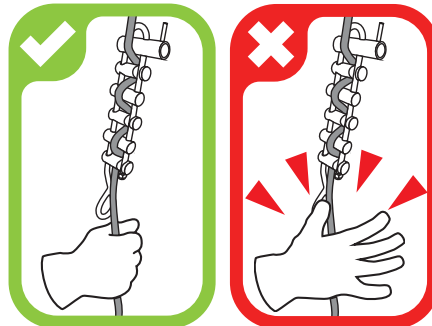

Brake bar racks do not have an auto-lock function. The user must keep a firm grip on the brake strand of the rope to maintain control unless the brake bar rack is tied off. FAILURE TO KEEP A FIRM GRIP ON THE ROPE COULD RESULT IN INJURY OR DEATH.

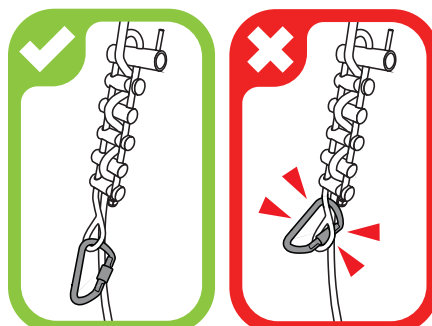

BRAKE BAR RACKS CAN ACT AS A LEVER THAT CAN DAMAGE OR BREAK CARABINERS WHICH COULD RESULT IN INJURY OR DEATH. Always check that the brake bar rack is properly positioned in the basket of the carabiner before weighting the rope.

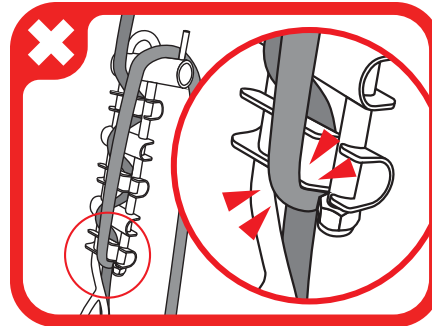

Do not use the Tie-Off Bar to slow your descent when using U-shaped brake bars. THE FRICTION OVER THE STRAIGHT EDGE OF THE BRAKE BAR MAY CAUSE EXCESSIVE WEAR AND/OR DAMAGE TO THE ROPE AND COULD RESULT IN INJURY OR DEATH.

BEFORE USE

The techniques employed in the proper and safe use of this equipment may only be learned through PERSONAL instruction received from an instructor who is well-qualified in all phases of vertical rope work. Such instruction will include an evaluation of your comprehension of, and ability to perform, the tasks required to safely and efficiently use this equipment.

Never attempt its use until you have received such instruction and are believed competent by your instructor.

Do not expose the rope or webbing used with the descent control device and any other software to flame or high temperatures and carry the equipment where it will be protected as it could melt or burn and fail if exposed to flame or high temperatures.

INSPECTION FOR USE

Visually and by touch, inspect this Rappel Rack for cracks, distortion, corrosion, scratches or gouges, wear grooves with sharp edges or rough areas that might damage a rope. Confirm that the Nylon lock nuts are properly installed (see figs. 1 & 2). Compare this Rappel Rack with a new model if necessary to determine its condition. Remove each part from service if there is any doubt about its safety or serviceability.

MAINTENANCE AFTER USE

Carefully clean and dry this Rappel Rack to remove all dirt or foreign material and moisture. Minor sharp edges may be smoothed with a fine abrasive cloth, before cleaning. Store in a clean, dry place.

REMOVAL FROM SERVICE

This Rappel Rack should be removed from service if it has been dropped, or exposed to heat sufficient to alter its surface appearance, or if distortion of any part is apparent, or if any cracks are apparent, or if it has scratches or gouges of more than a superficial nature. Replace and remove from service brake bars with wear grooves with sharp edges. The cost to inspect and repair a Rappel Rack that is visually damaged, or that may have been damaged by impact loading or other abuse, will exceed the cost of its replacement with a new model.

RECORDS

It is suggested that the user of this Rappel Rack keep a permanent record listing the date and results of each usage inspection. Such record should show, as a minimum, inspection for all of the following conditions:

- Cleanliness
- Dryness
- Freedom from scratches, gouges and sharp edges
- Freedom from corrosion
- Freedom from distortion
- Excessive wear on brake bars from rope friction
- User Information sheet present

USE OF THIS USER INFORMATION SHEET

It is suggested that this User Information sheet be retained in a permanent record after it is separated from the Rappel Rack, and that a copy of it be kept with the Rappel Rack.

It is suggested that the user refer to this User Information sheet before and after each use of the Rappel Rack.

LIFESPAN

The service life of Rappel Racks are largely dependent on the type of use and the environment used in. Under moderate use, with limited exposure to moisture, salt water, corrosive agents, excessive loads, shock loading and excessive wear, Rappel Racks may last many years. However, many events such as taking a large dynamic load, dropping, or other events which cause physical damage, can reduce the lifespan of this Rappel Rack dramatically.

Nylon lock nuts should be replaced if they have been removed and reinstalled more than two times. Contact SMC for replacement nuts.

You must inspect your Rappel Rack frequently and take personal responsibility for evaluating its condition and retiring unsafe gear. Inspection is extremely important, but visual inspection only will not assure that damage has not occurred. If the history of the Rappel Rack is unknown or if based on the history of the use of this Rappel Rack there is any doubt regarding the safety of this Rappel Rack, it should be removed from service. You should destroy retired gear to prevent future use.

GENERAL ASSEMBLY

All SMC rappel rack products require assembly by the user. If you are not comfortable assembling a rappel rack, seek qualified help.

TOOLS REQUIRED:

- NFPA rappel racks: 9/16" wrench
- Micro rappel rack: 1/2" wrench

GENERAL ASSEMBLY INSTRUCTIONS:

1. Load brake bars as indicated in the instructions for each model
2. Install one Nylon lock nut for J-Racks and two Nylon lock nuts for U-Racks. Use a wrench to tighten nut(s) until there is one full thread exposed above the white Nylon portion of the nut (fig. 1). If nut(s) cannot be installed so that there is one full thread exposed (fig. 2), do not use rappel rack and contact SMC immediately.

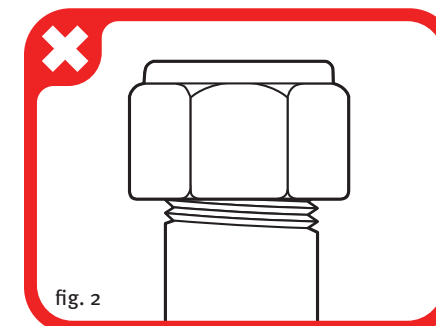
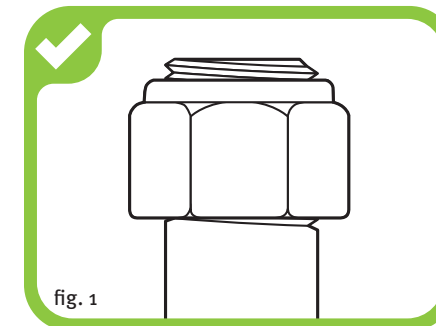

WARNING:

IMPROPERLY INSTALLING RAPPEL RACK NUTS COULD RESULT IN INJURY OR DEATH.

This assembly and tie off information is not a substitute for the personal instruction which each user must receive, as described above. Any attempt to use an improperly rigged rappel rack can result in the sudden loss of all braking action, resulting in serious injury or death.

U-RACKS

MICRO RAPPEL RACK KIT (13700)

MICRO RAPPEL RACK PARTS LIST:



Q'TY	DESCRIPTION
1	Micro Rappel Rack Frame
2	Micro Stainless Tie-off Bars
1	Micro Bar, Angled slot
1	Micro Bar, Straight slot, black
2	Stainless Nylon Nuts
1	User Instruction

This device is designed to be used with rope diameters from 7mm to 12.5mm. This rack has an MBS of 8kN to 22kN dependent on the rope diameter used. This device is not NFPA certified.

4 BAR U-RACK KIT (NFPA14400)



4 BAR U-RACK PARTS LIST:

Q'TY	DESCRIPTION
1	NFPA 4 bar U Rack
2	2-Hole Tie-Off bars
1	1" Stainless Brake Bar, Angled slot
1	1" Stainless Brake Bar, Straight slot, black
2	Stainless Nylon Nuts
1	User Instruction

U-RACK ASSEMBLY:

For right-handed use: With the open end of the frame facing away from you, install the polished, angled-slot bar onto the right leg of the frame with the slot facing up and on the left leg of the rack. Add one of the tie-off bars to both legs of the frame with the horn on the right and pointed toward the U-end of the frame. Install the black straight-slot bar on the right leg of the frame with the slot facing up and on the left leg of the rack. Install the other tie-off bar on both legs of the frame with the the horn on the right side of the rack pointed toward the open end of the frame.

All bars must be arranged in this alternating manner so that when the rope is loaded, it will contact each bar on the side opposite the slot and force the slotted bars closed against the frame.

Install the Nylon lock nuts and tighten with a wrench (1/2" for 13700, 9/16" for NFPA14400) so that they both contact the tie-off bar evenly and the nylon portion of the hex nut is fully engaged. One complete thread should protrude past the nylon. See GENERAL ASSEMBLY figs. 1 and 2.

For left handed use: reverse these steps so the slots are on the right leg of the rack, and the horns are on the left side of the rack.

U-RACK TIE-OFF:

1. Load the rope into the rack so that rope forces all the slotted bars closed against the frame (fig. 3)
2. From the bottom brake bar, wrap the brake strand around the back of the top tie-off bar. The rope should be on the front side of the lower tie-off bar (fig. 4)
3. Pass the brake strand under the lower tie-off bar, wrap it over the standing end of the rope then pass it under the lower tie-off bar (fig. 5)
4. Tie a clove hitch on a bight around the entire brake rack. The clove hitch must straddle the lower tie-off bar (figs. 6 & 7)



fig. 3



fig. 4



fig. 5



fig. 6



fig. 7

6 BAR RACKS

6 BAR FLAT RACK KIT (NFPA14001)



6 BAR TWIST RACK KIT (NFPA14002)



6 BAR LONG RACK KIT (NFPA14003)



6 BAR RACK PARTS LIST:

Q'TY	DESCRIPTION
1	NFPA 6 Bar Rappel Rack Frame or NFPA 6 Bar Twist Rappel Rack Frame or NFPA 6 Bar Long Rappel Rack Frame
4	7/8" Angled Brake Bars, bright
1	7/8" Straight Brake Bars, blue
1	Stainless Tie-off Bar
1	Stainless Nylon Nut
1	User Instruction

6 BAR RACK ASSEMBLY:

Load one bright aluminum bar on the short leg of the rack such that the slot is to the right and facing away from you. Load a second bright aluminum bar so that the slot is to the right and facing toward you. Continue loading the bright bars, alternating the slot orientation. Load the blue straight slot bar last, continuing to alternate the slot orientation.

Slide aluminum bars around top of rack so they hinge on the long leg of the rack.

Load the Stainless Tie-Off Bar so it hinges on short leg of rack and is positioned above the blue straight slot bar.

All bars must be arranged in this alternating manner so that when the rope is loaded, it will contact each bar on the side opposite the slot and force the slotted bars closed against the frame (fig. 8).

Install supplied Nylon lock nut and tighten with a 9/16" wrench until one complete thread protrudes past the nylon. See GENERAL ASSEMBLY figs. 1 and 2.

For left handed use: reverse these steps so the slots are on the right leg of the rack, and the horns are on the left side of the rack.

During use, the rope may be wrapped over the tie off bar one or two times to increase friction when heavy loads are involved or a high degree of control is required (fig. 9).



6 BAR RACK TIE-OFF:

1. Load the rope into the rack so that rope forces all the slotted bars closed against the frame (fig. 8)
2. Wrap the brake strand over the tie-off bar twice (fig. 9)
3. Tie an overhand on a bight around the entire rack (figs. 10, 11, & 12).



fig. 8



fig. 9



fig. 10



fig. 11



fig. 12

ACCESSORIES

BRAKE BAR FRAMES

	13002 STANDARD 6 BAR FRAME
	13502 TWISTED 6 BAR FRAME
	13311 LONG 6 BAR FRAME
	13105 U-RACK 4 BAR FRAME

TIE-OFF BARS

	12110 TWO HOLE TIE-OFF BAR, STAINLESS, U-RACK
	12301 TIE-OFF BAR, 6 BAR RACK

STANDARD BRAKE BARS

	11000 7/8" BRAKE BAR, STAIN- LESS, GROOVED
	12010 1" BRAKE BAR, STAIN- LESS, ANGLED SLOT
	12020 1" BRAKE BAR, STAIN- LESS, STRAIGHT SLOT
	12201 7/8" BRAKE BAR ALUMI- NUM, ANGLED SLOT
	12401 7/8" BRAKE BAR, ALU- MINUM STRAIGHT SLOT
	12500 U-SHAPED BRAKE BAR, STAINLESS, ANGLED
	12501 U-SHAPED BRAKE BAR, STAINLESS, GROOVED
	12605 7/8" BRAKE BAR, ALU- MINUM, GROOVED

User Instructions



Quality Gear for Life

RAPPEL RACK KITS & ACCESSORIES



ASSEMBLY REQUIRED

Made in the USA by

Seattle Manufacturing Corporation
6930 Salashan Parkway
Ferndale, Washington 98248
800.426.6251 | www.smcgear.com

LIMITED WARRANTY

SMC products are warranted to the general specifications of use listed on www.smcgear.com and within product user instructions. Items that are claimed to be defective must be returned under a pre-assigned Return Authorization/CC Number and should include a detailed description of the conditions existing during use of the item, the place and date of the original purchase as well as a copy of the original invoice or receipt. Items being sent in for inspection may or may not be returned if the product in question is deemed potentially unsafe or non-functional, and a replacement may be sent at no-cost or at discount as deemed by SMC. See smcgear.com/terms.

If you do not completely understand any of the outlined user instruction provided on this sheet or if you have any questions please contact SMC at 360-366-5534 or info@smcgear.com.

140120

Information for your permanent records:

Date of Purchase: _____

Purchased From: _____

Part Number: _____